

Inside Weather



KOBE • LUNA • POLK DINING CHAIRS

Gather Your Eggs...

The parts shown here are all the available options. The parts you have will depend on your custom order.

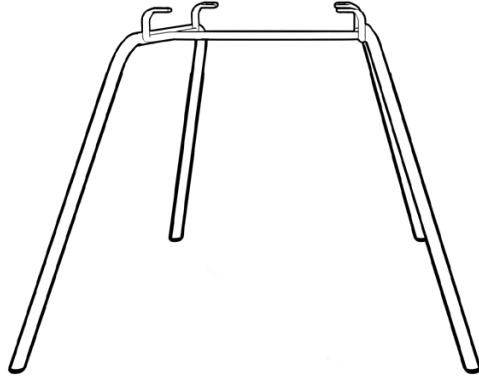

LEGS



CHAIR BODY

You should have:

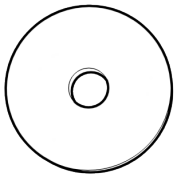

2x Thick Rubber Washers

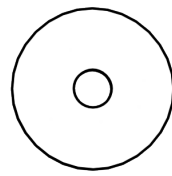

2x Thin Rubber Washers

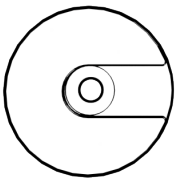

2x Pucks



2x Puck Connectors



2x Long Button-Head Screws



2x Short Flat-Head Screws



4x Metal Washers



2x Short Button-Head Screws



1x Hex Key

Note: Please retain all boxes until you are certain that your product isn't damaged and that you do not wish to return it. Disposal of boxes may prevent/delay our ability to resolve your request.

Before You Start

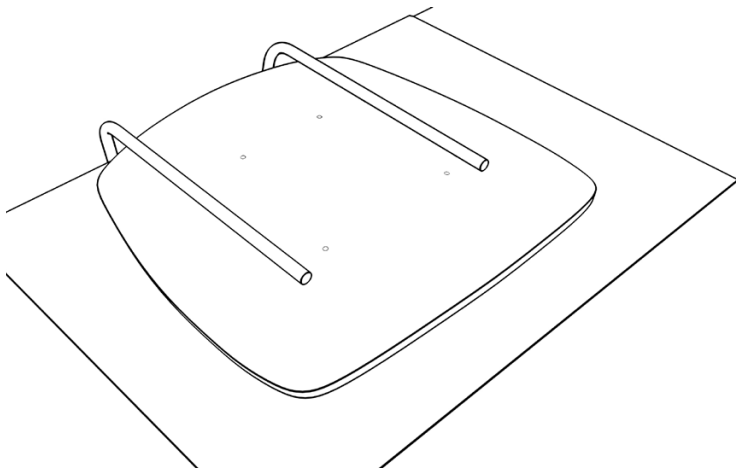

The easiest way to assemble the chair is to have the seat lying flat. This can be arranged by hanging the seat of the chair over the edge of an elevated flat surface, such as a table, or even the box in which the chair arrived!

Lay down a towel or blanket between the chair and your surface of choice in order to avoid any scratches or scuffs.

Heat your oven to 350°F and throw some nachos in there so you have something to eat when you're done. Should be about 10 minutes.

Step 1: Place Washers and Attach Pucks

Back Washers

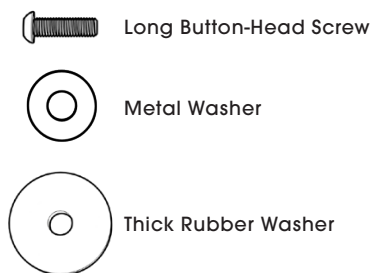

Front Pucks

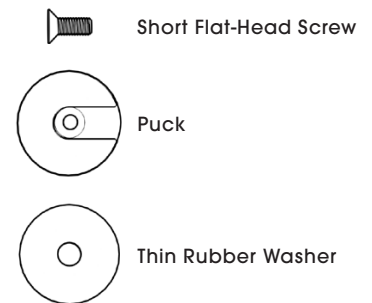

- Place a thick rubber washer over each of the 2 mounting holes located towards the back of the seat
- Place a skinny rubber washer over each of the 2 mounting holes located towards the front of the seat.
- Place a puck on top of the front thin washers. Make sure the slotted-side is facing up.
- Fasten both pucks using a flat-head screw. Do not fully tighten until next step.

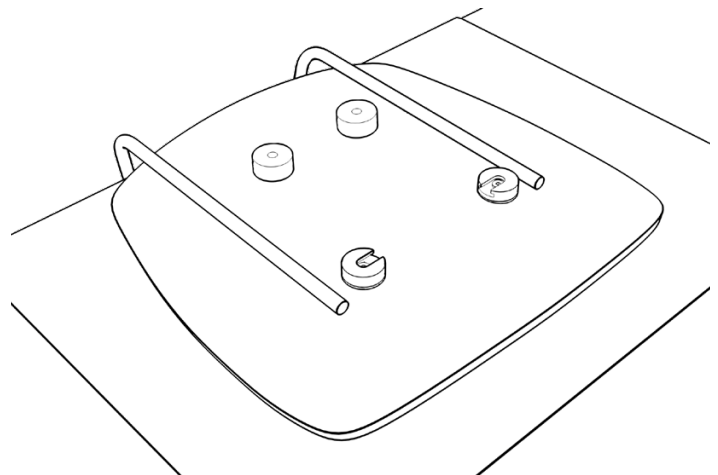

Step 2: Attach the Base

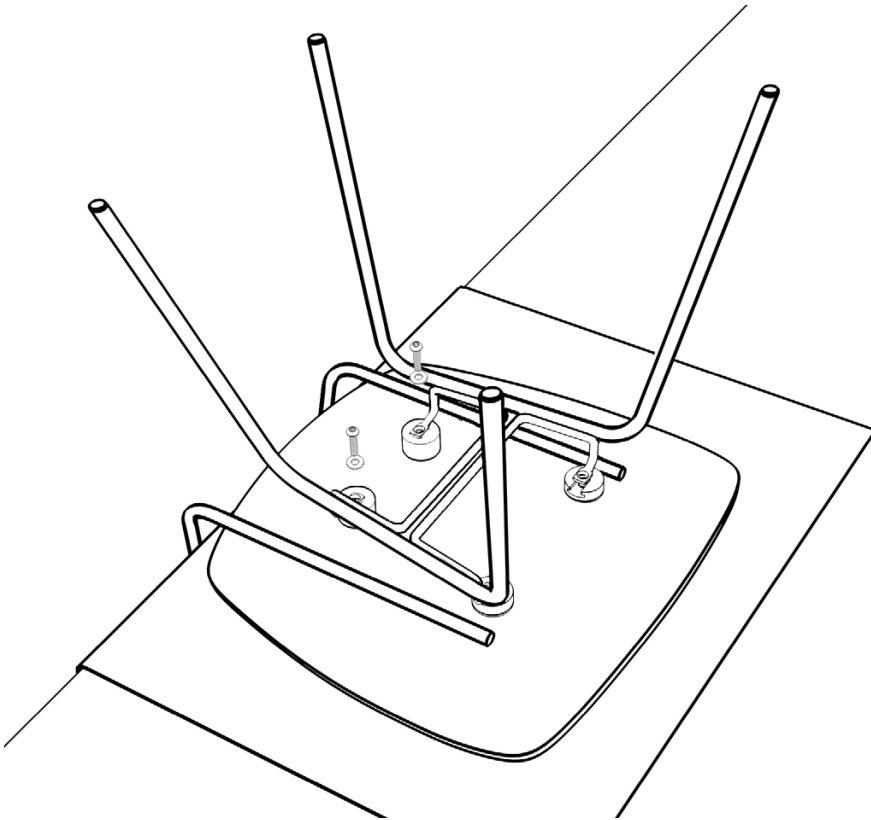

Flip the chair base onto the seat so that the back leg mounting holes align over the back washers and the front leg mounting holes align over the slot of the pucks.

Note: chair bases have a front and a back, so if they don't align at first, the legs are probably sideways or backwards. Rotate the base 90° or 180° and try again.

Next, take your long button-head screw with a metal washer and insert through the back leg mounting holes and lightly tighten so that your legs are in position.

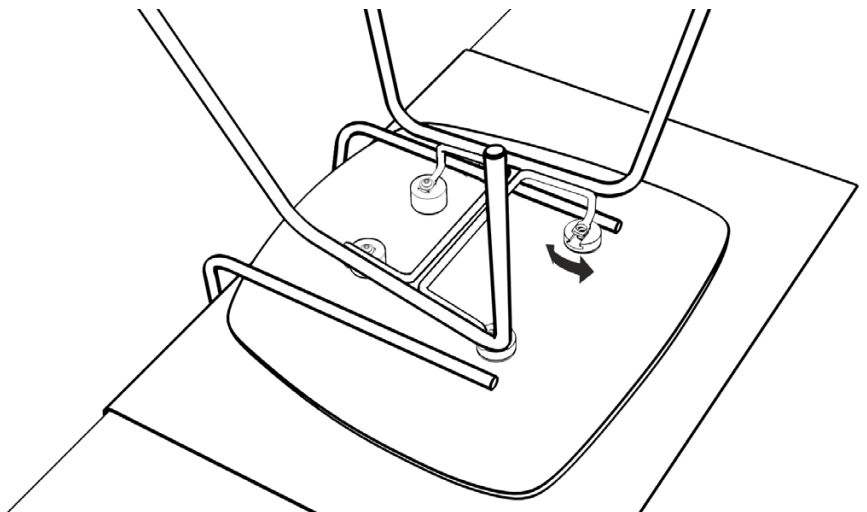

With the back secure, pivot the front pucks so that the mounting holes align with the slot on the puck. Once you have the front pucks in position, use your hex key to fully tighten the flat head screw in the puck.

Note: Ensure the tab of the mounting hole is not parallel with the slot as this can cause the hardware to slip.

NO

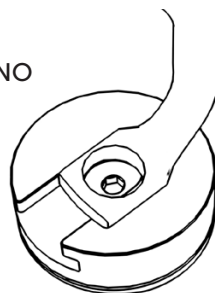

YES

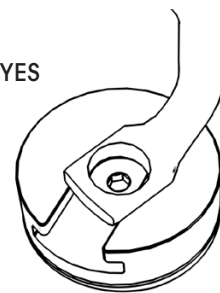

Step 2: Attach the Base

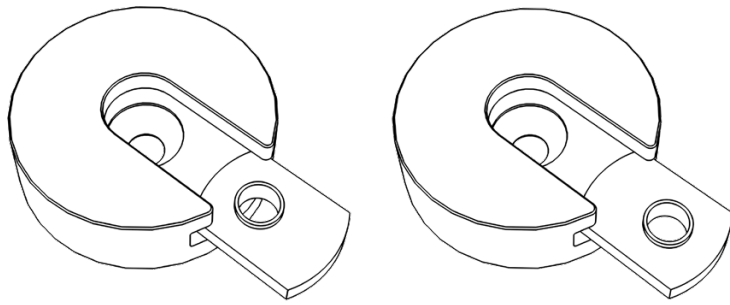

Grab your puck connectors and slide 1 into each puck. If your mounting holes are closer to the center of the puck, insert the short side first. If they are closer to the edge, insert the long side first.

- Move the connector into position so that the threads align with the leg mounting hole on the chair base.
- Place a washer over the leg mounting hole and insert a button-head screw and lightly tighten.
- Repeat on other side

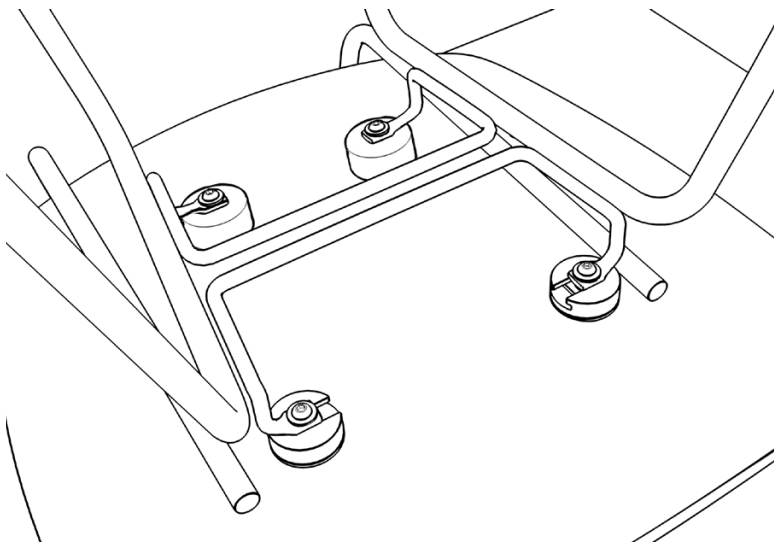
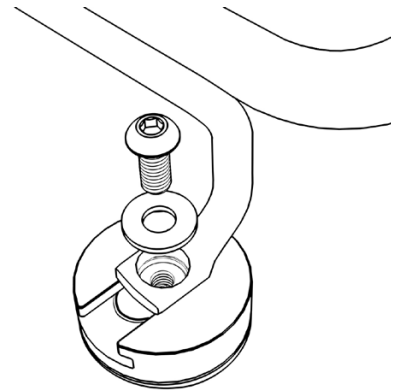

- Once all screws are inserted, tighten both of the front screws.
- Move to the back legs and fully tighten
- Flip the chair onto its legs.



DONE!