

Inside Weather

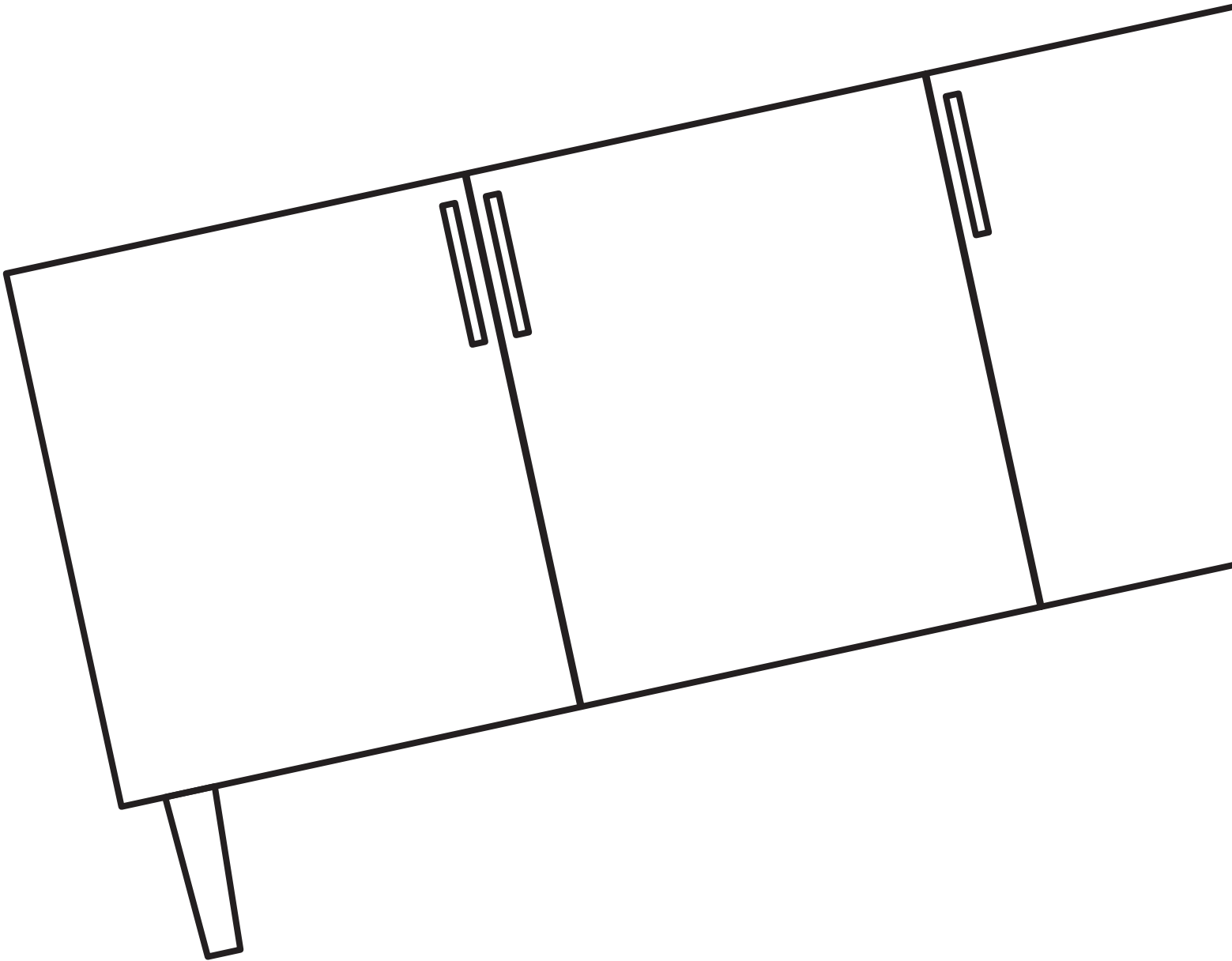

**VOSS SIDEBOARD**

## Gather Your Eggs...

2x Back Panels

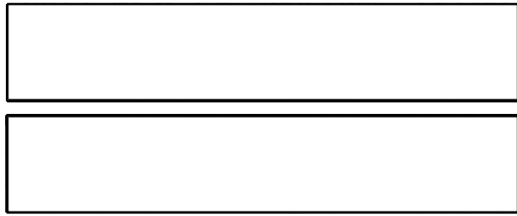

1x Top Panel



2x Side Shelves



1x Middle Shelf



2x Side Panels

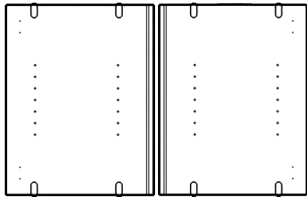

2x Dividers

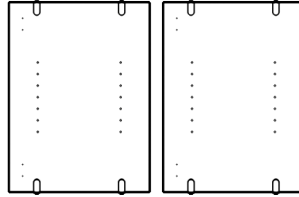

1x Bottom Panel



3x Doors

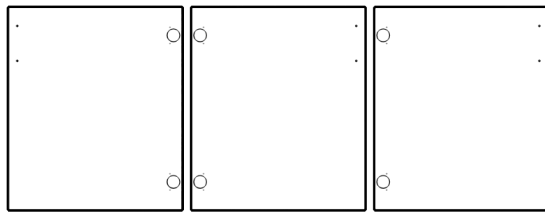

## More Eggs...

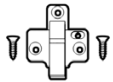

6x Hinge Connector Hardware  
with 12x Screws

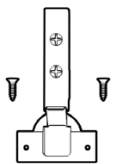

6x Door Hinges  
with 12x Screws  
(2x will be arced)

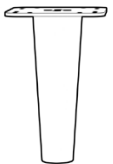

4x Legs



16x Leg Screws



12x Shelf Pins

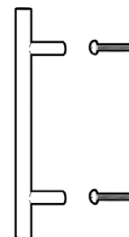

3x Door Handles  
with 6x Screws



3x Adhesive Plastic Bumpers



16x Screw Connector Covers

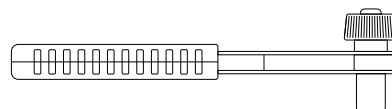

Ratchet



Long Hex Bit

Note: Please retain all boxes until you are certain that your product isn't damaged and that you do not wish to return it. Disposal of boxes may prevent/delay our ability to resolve your request.

# Step 1: Attach the Hinge Connector Hardware

Grab your side panels, divider with mounting holes, hinge connector hardware and matching screws.

Identify the mounting holes in the side panel. They look like vampire bites.

Repeat for divider.

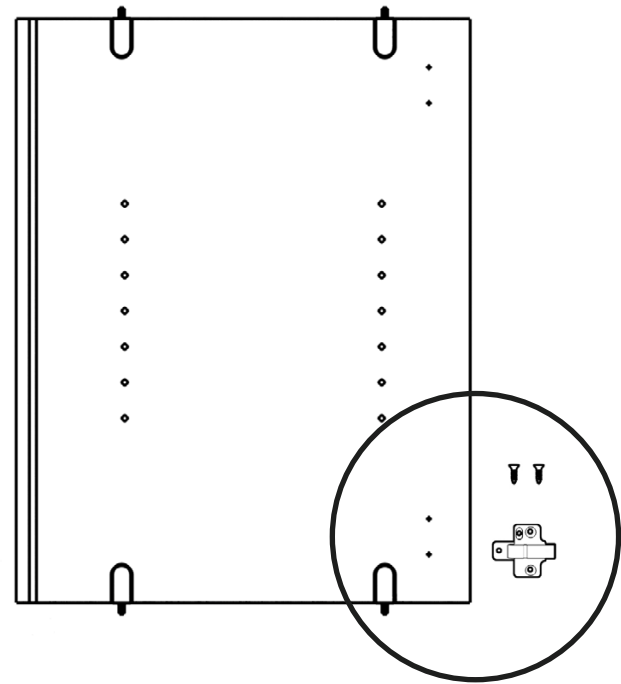

- Check the orientation: the C-shaped groove should face the nearest edge
- Fasten with screws. Use a Phillips Head Screwdriver to tighten screws
- Each side panel should have 2 hinge connectors

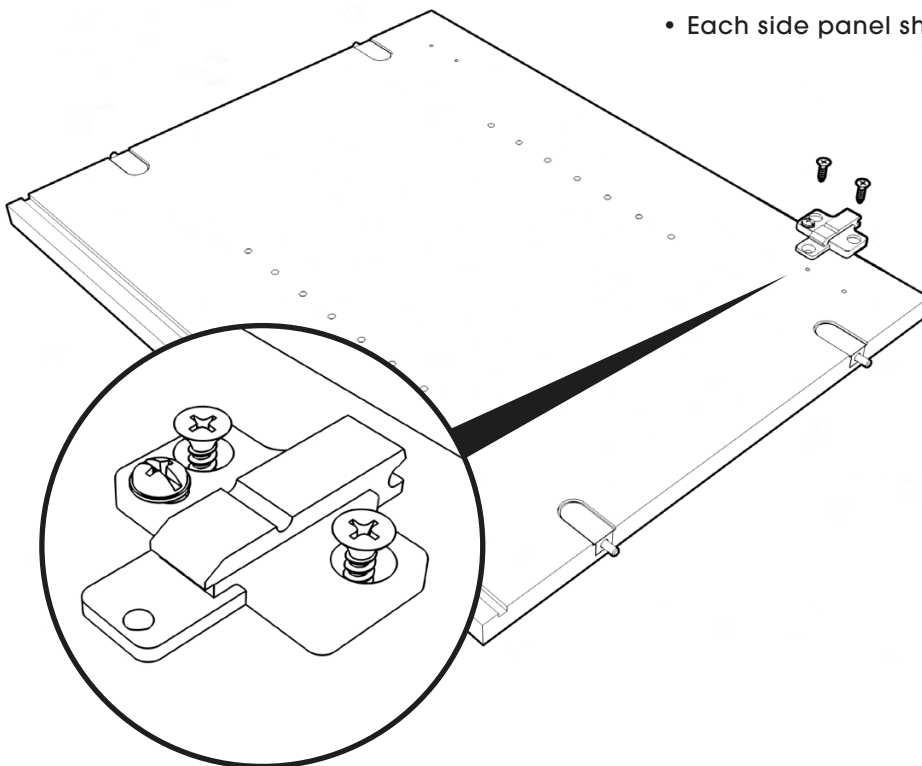

# Step 2: Attach Lower Back Panel to Bottom Panel



Lower Back Panel

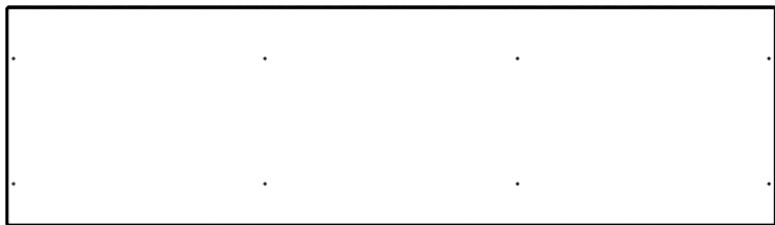

Bottom Panel

Place your bottom panel with the leg holes facing down.

Align and center the grooves of the lower back panel to the corresponding grooves in the bottom panel and press down.

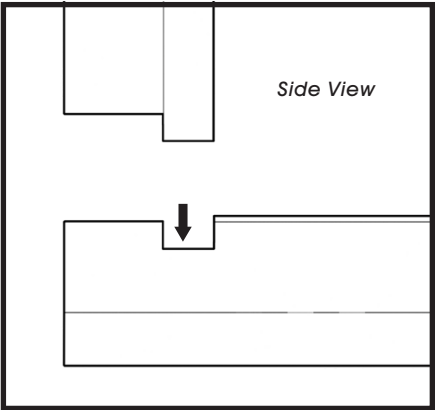
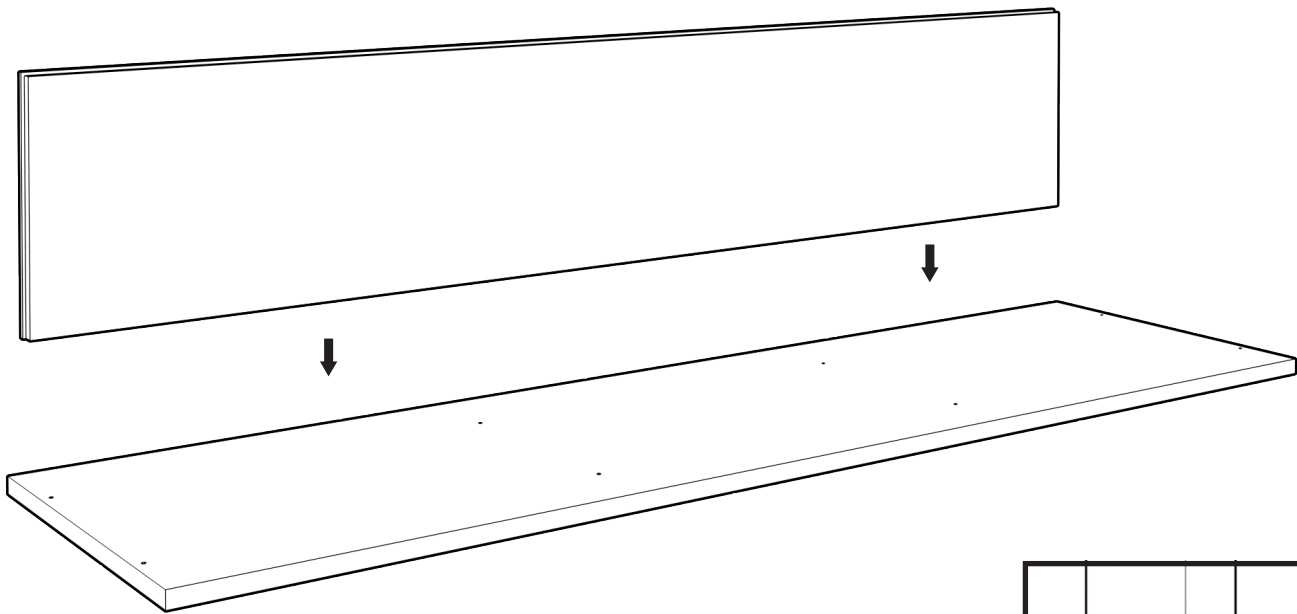

## Step 3: Attach Side Panels

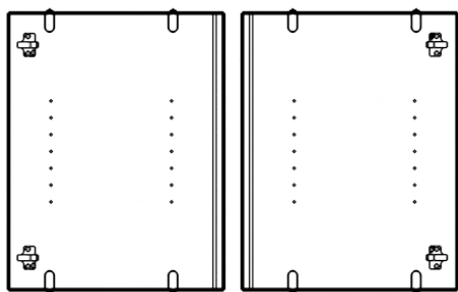

Side Panels

Align the plastic connectors on the side panel with the corresponding holes on the bottom panel.

Fasten using provided ratchet.

Repeat for both sides.

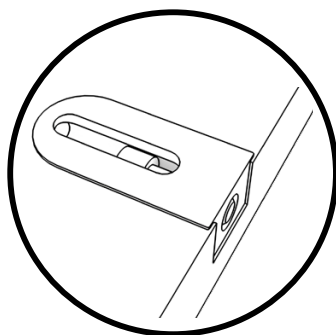
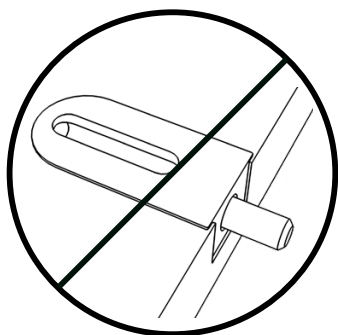
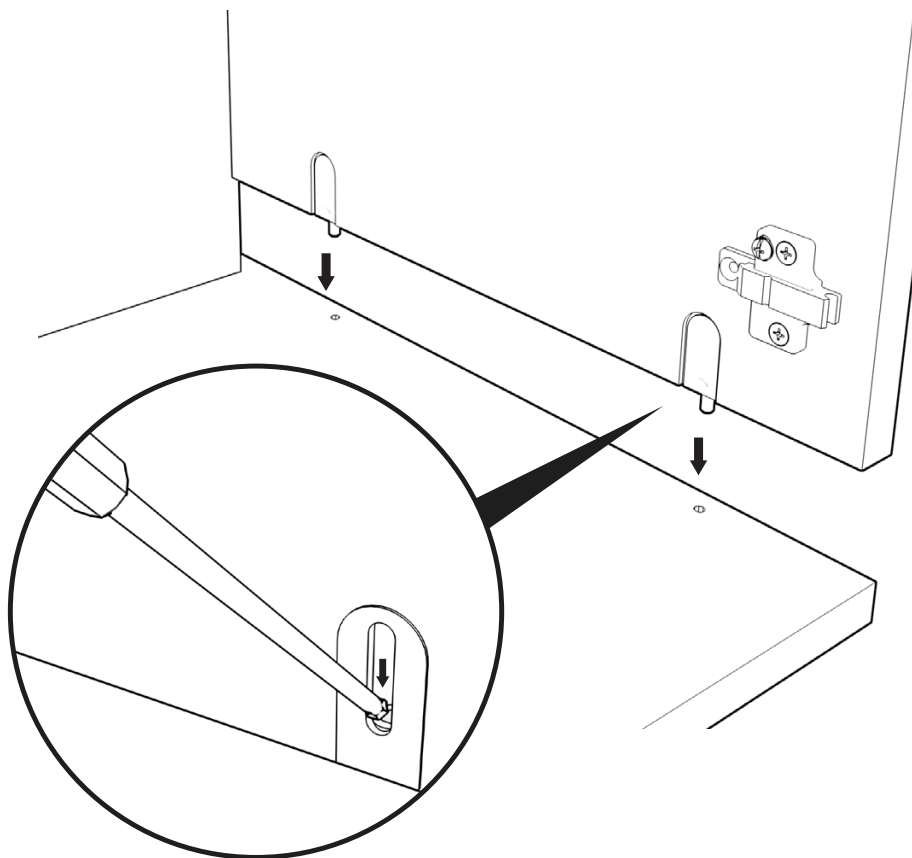

Note: When fitting the pieces together, make sure the connecting screws are retracted inside their housing. Having the screw out could damage your surfaces.

## Step 4: Attach Upper Back Panel

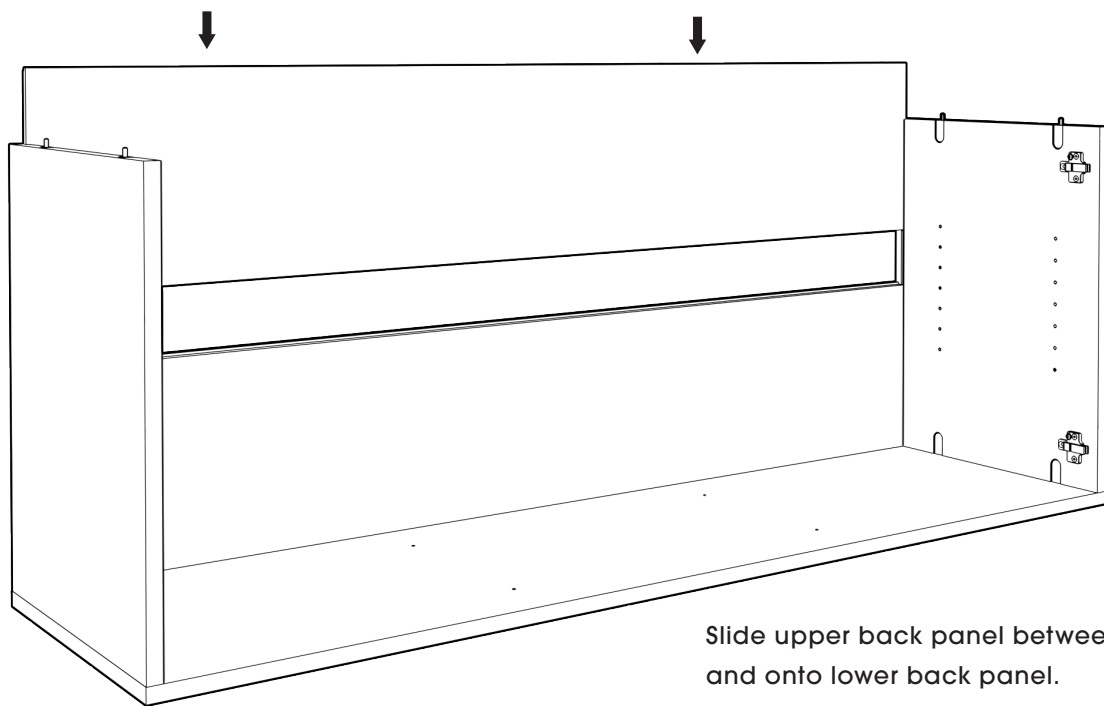

Slide upper back panel between side panels and onto lower back panel.

## Step 5: Attach Inside Divider Panel

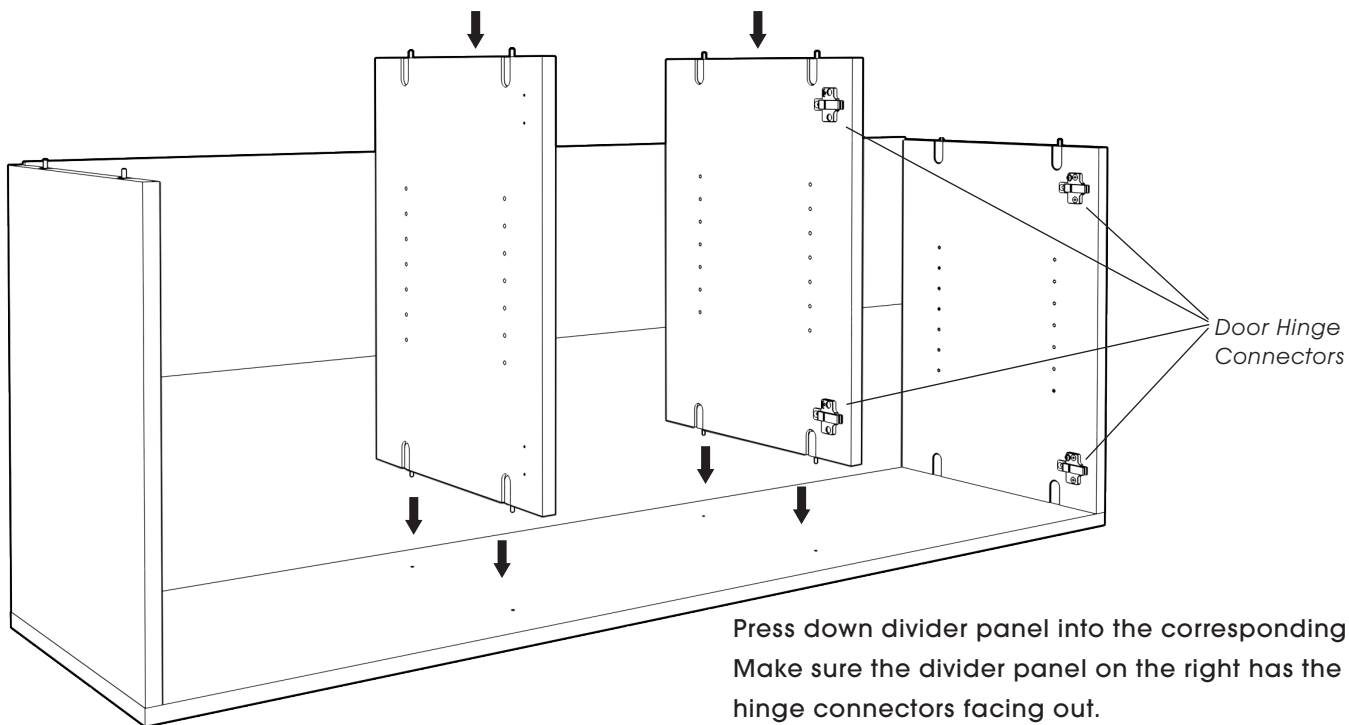

Press down divider panel into the corresponding holes. Make sure the divider panel on the right has the door hinge connectors facing out.

Fasten using provided ratchet.

Make sure connecting screws are visible on all pieces.

## Step 6: Attach the Top Panel

Grab your Top Panel. Line up the connectors in the side panels and center dividers with the holes on the top panel. Ensure the back is aligned with the groove on the top.

Fasten using provided ratchet.

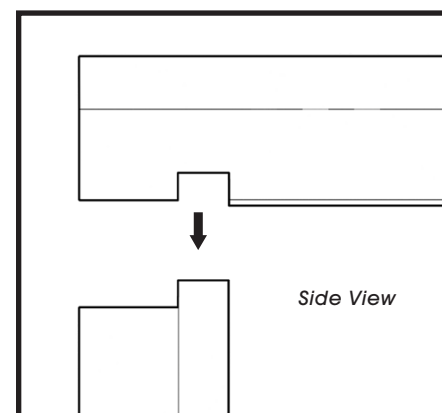
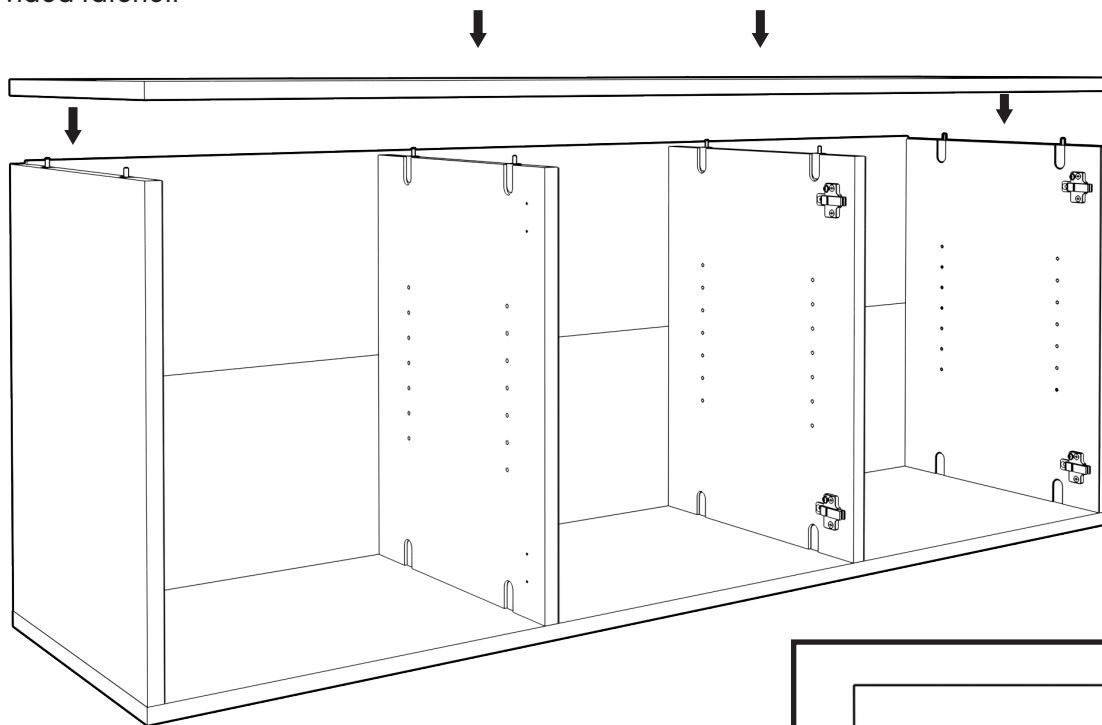

## Step 7: Attach the Legs

Rotate the unit onto its back.

Attach the legs using the leg screws. There are 4 screws to each leg.

Note: flared legs should each point outward towards their respective corners.

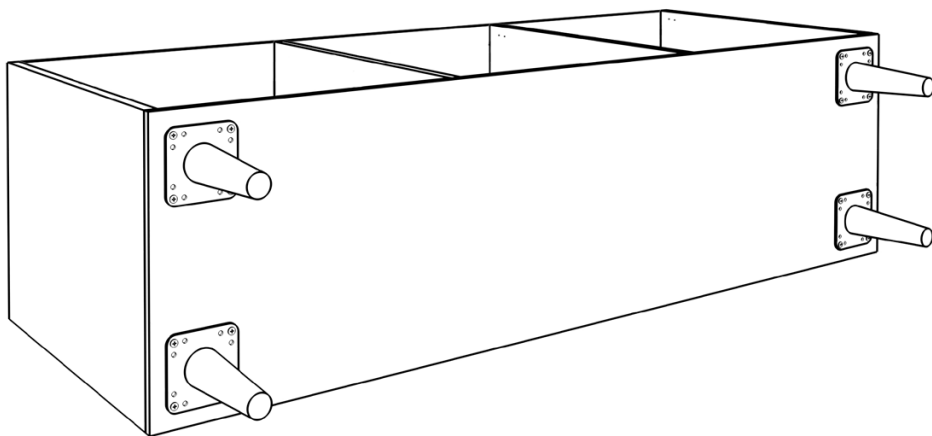
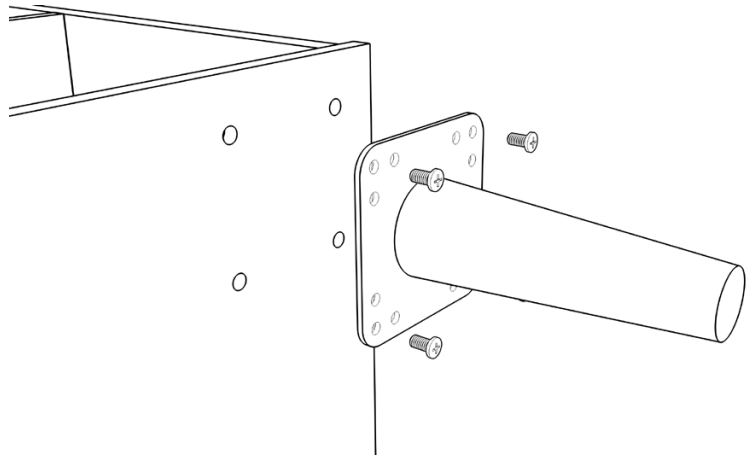

Repeat for remaining legs

Flip the Sieboard back onto its feet

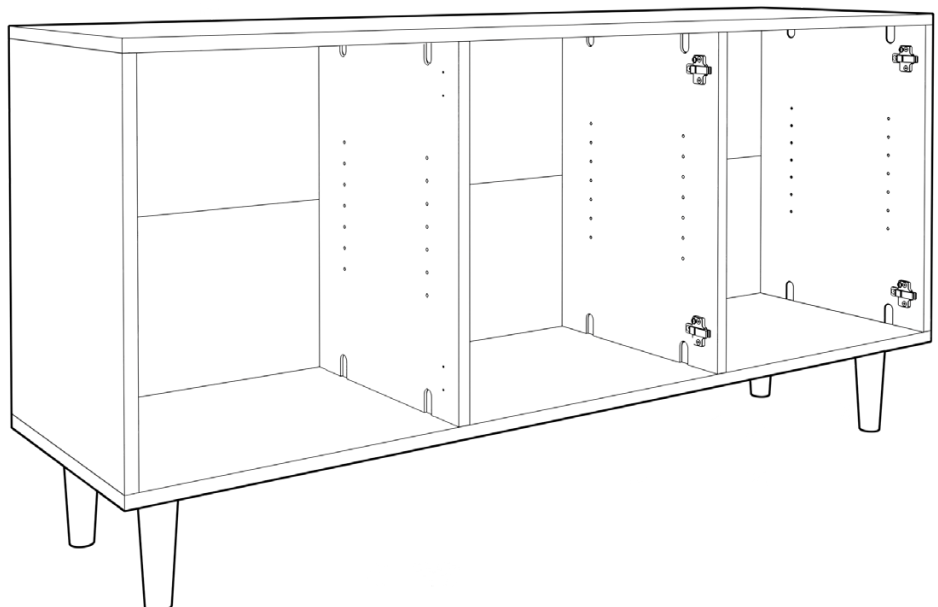



## Step 8: Install the Shelves

Add shelf pins to the desired height and place the shelves groove side down on top of the pins from above. Use four pins per shelf.

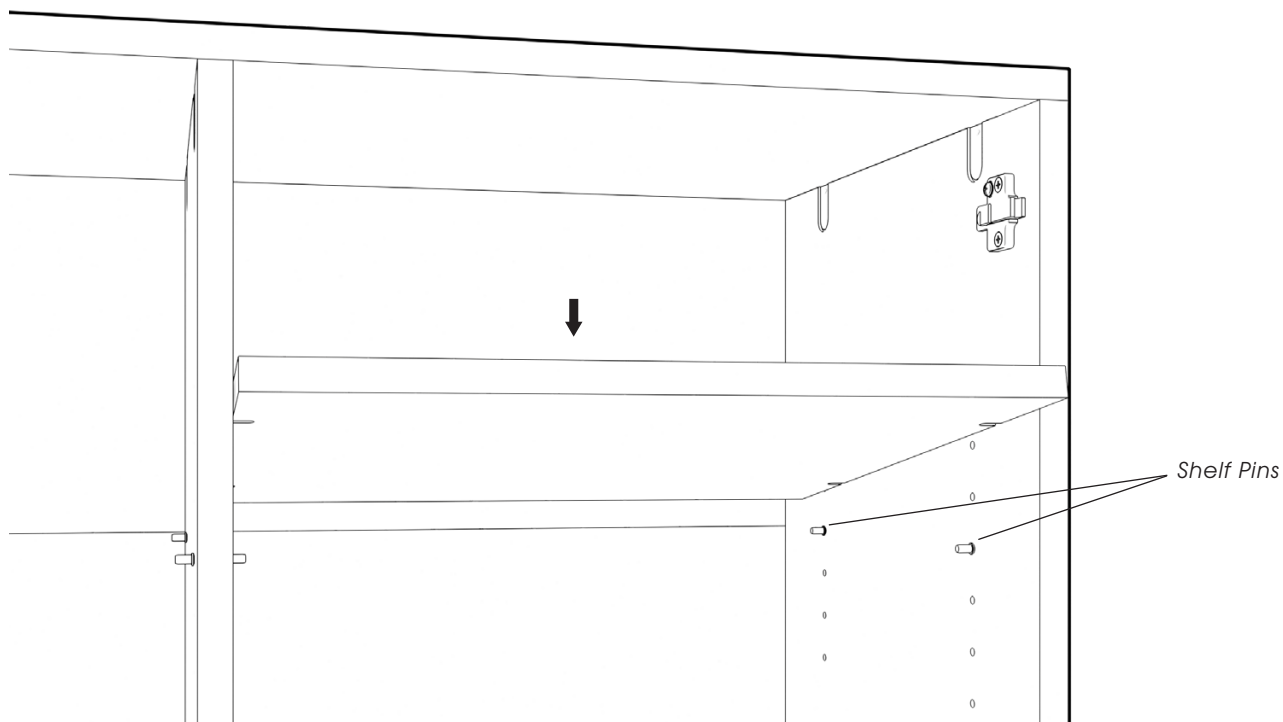

NOTE: There are two shelf types indicated by a notch on the center or on the side. The center notched shelves will be placed in the middle of the unit, and the side notched shelves will be placed on the sides.

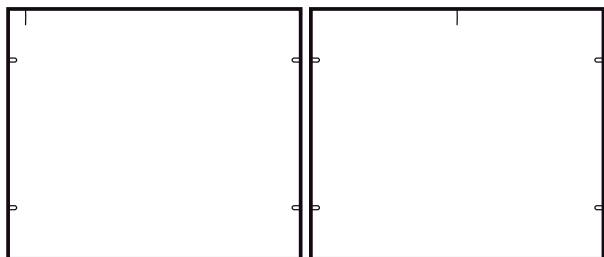

*Side Shelf*

*Center Shelf*

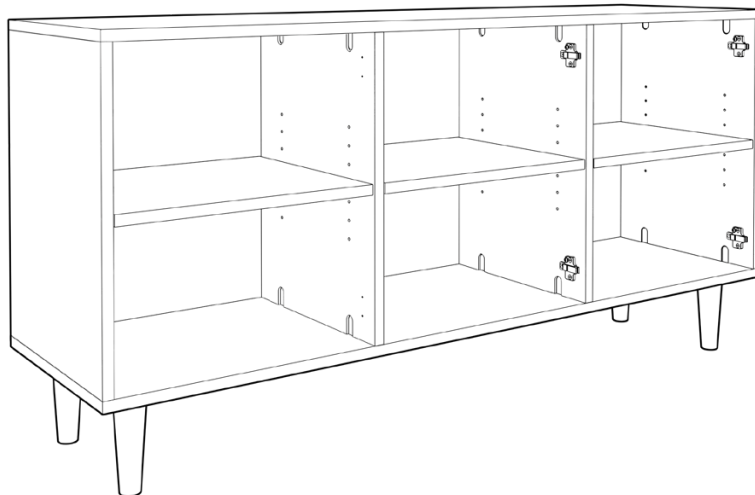

## Step 9: Install the Hinges

6x Door Hinges with 12x Screws

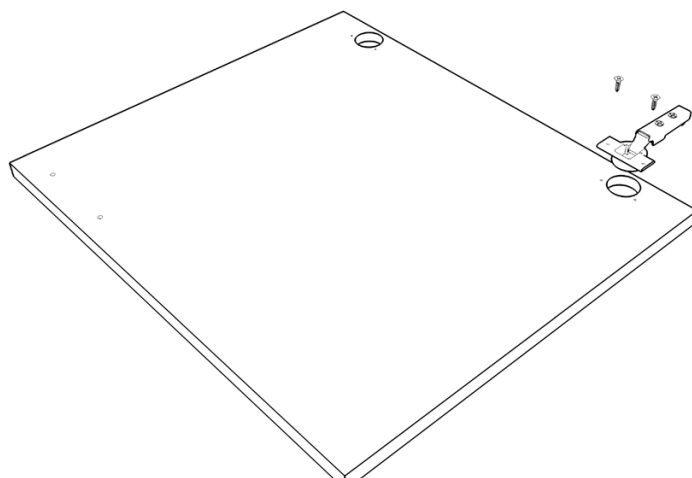
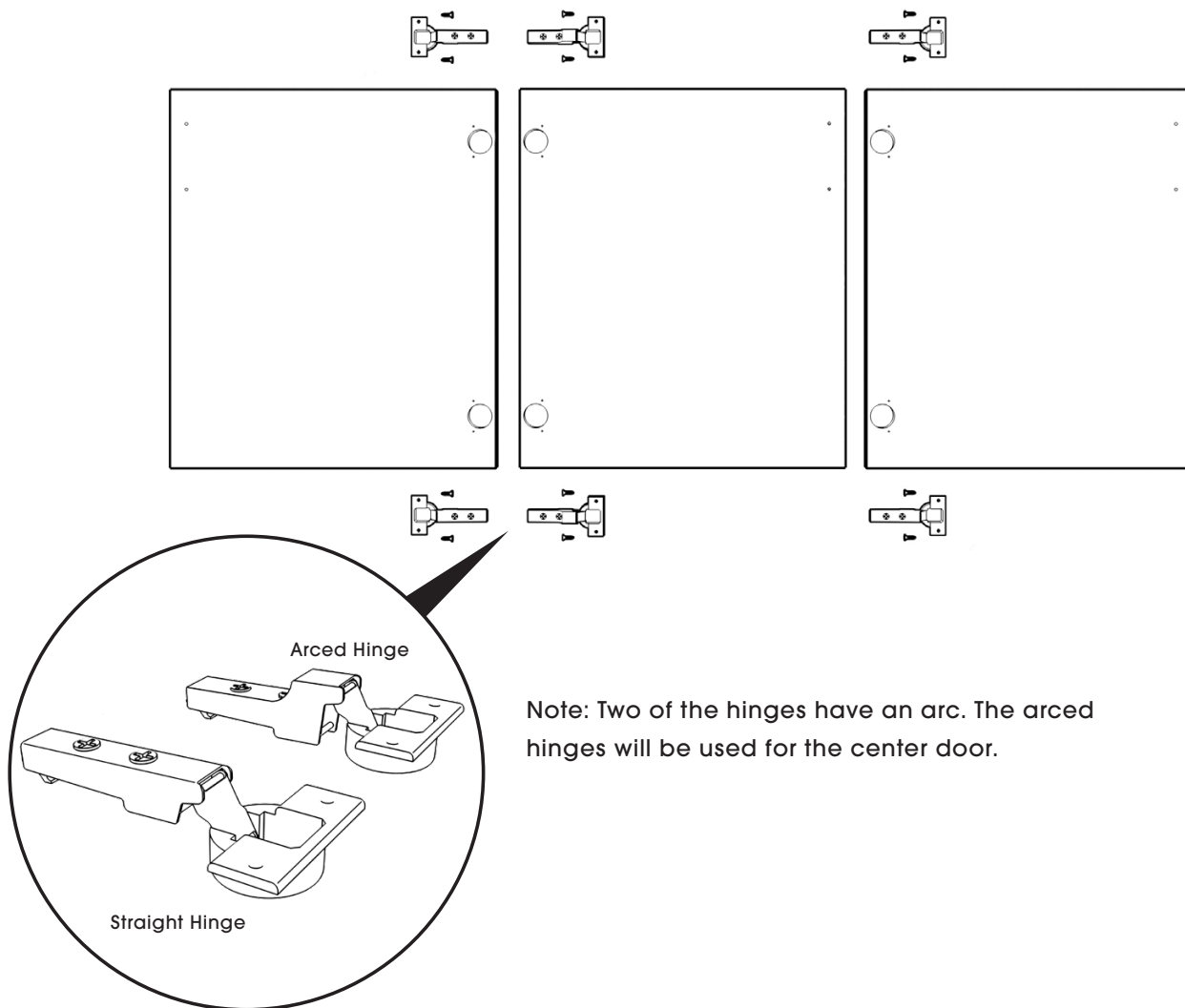

Place a hinge into each well on the inside of the door panel.

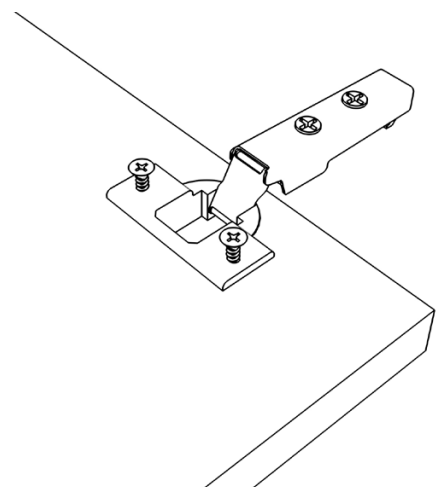

Insert a screw into each mounting hole and fasten. Repeat for the remaining hinges.

## Step 10: Attach the Doors

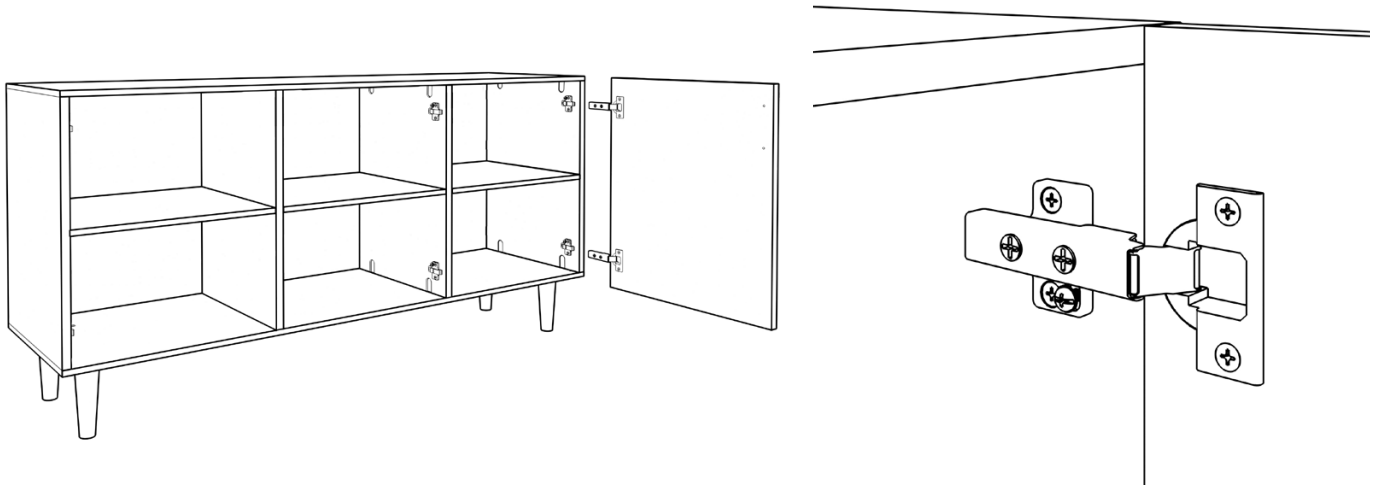

Rest the hinges over their receiving hardware. Make sure the doors are right-side up.  
Press the hinges into the hardware. They should just snap into place. See below.

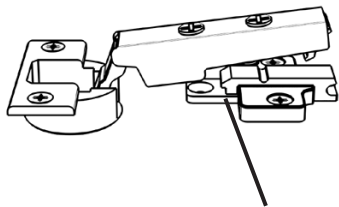

Slide hinge up against  
receiving hardware.

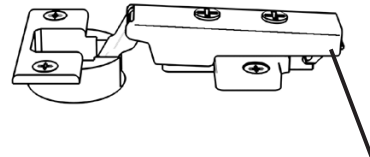

Push end down onto  
receiving hardware and  
snap in place.

## Step 11: Attach the Door Handles

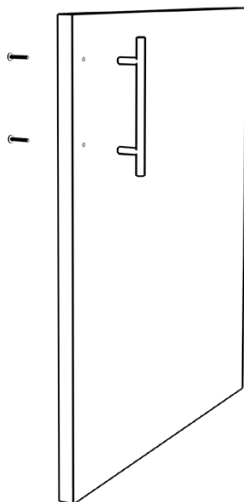

Insert the mounting screws from the  
inside of the door. Fasten to the handle  
on the other side.

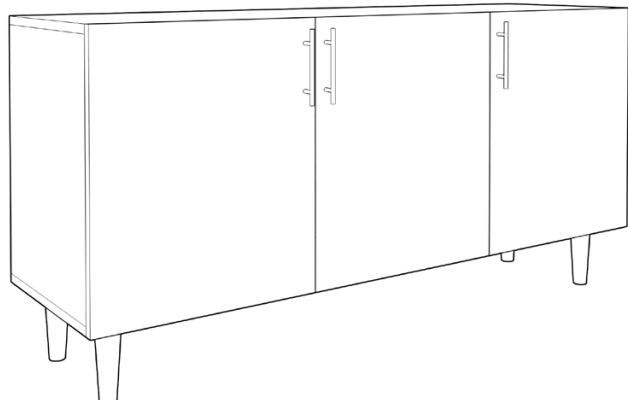

## Step 12: Adjust the Hinges and Center the Doors

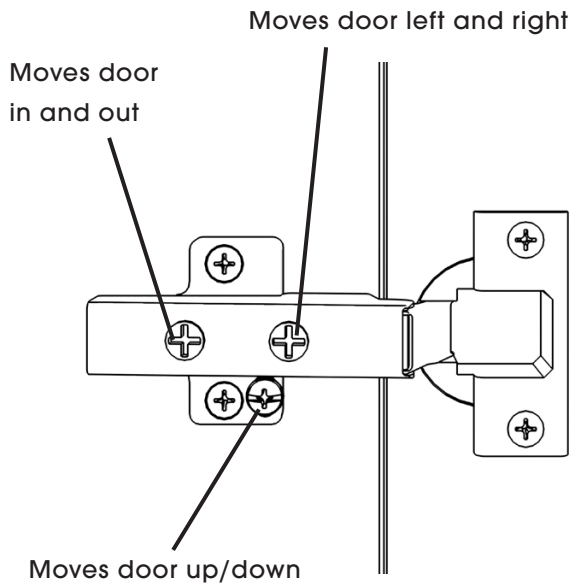

- Hinges are adjustable in 3 different locations.
- Each adjusts the position of the doors differently.
- Note the locations indicated in the image

### TIPS:

- Coordinate your adjustments for top and bottom hinges
- Begin by maxing out each adjustment point
- **Use manual screwdriver for fine-tune adjustments.**

### Adjustment 1: Move door to the left or right of the side panel.

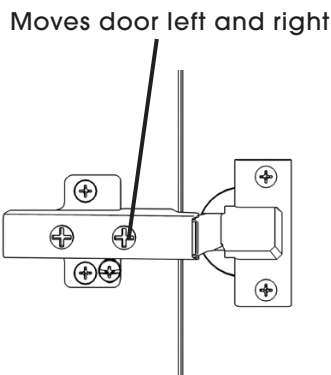

Use this adjustment to:

- Ensure a vertical center gap between doors
- Widen or narrow the center gap.

Note: The gap between the doors will taper, or slant, if the top and bottom hinges are not equally adjusted

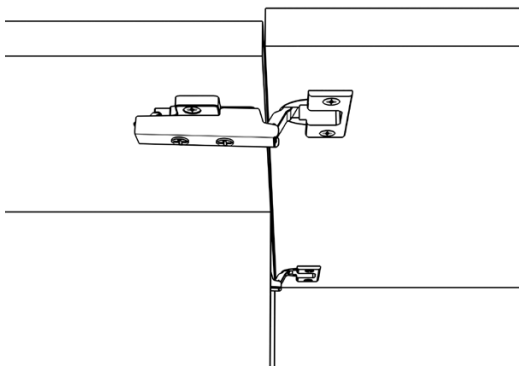

Door is adjusted too far to the right of the side panel. This creates a larger gap between the two doors.

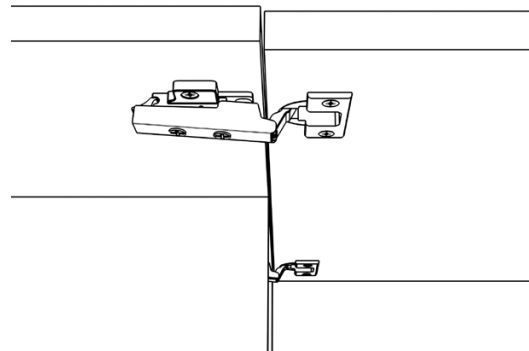

Door is adjusted too far to the left of the side panel. This creates a smaller gap between the two doors

## Adjustment 2: Move the door closer or farther away from the side panel.

Moves door  
in and out

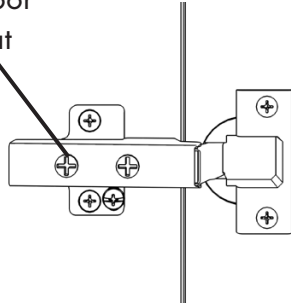

Use this adjustment to:

- Make the edges of the door parallel with the edges of the credenza.
- Widen or narrow the gap between the doors and credenza

Note: Check that the gap between the open door and side panel is vertical and does not taper.

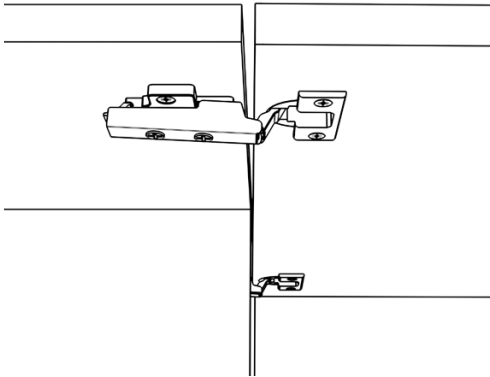

Door is adjusted to be farther away from credenza.

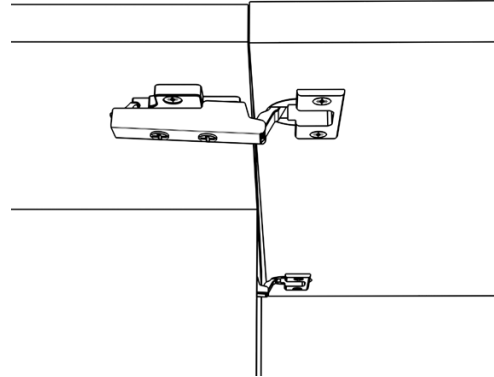

Door is adjusted to be close to the credenza.

## Adjustment 3: Move the door up or down.

Moves door up/down

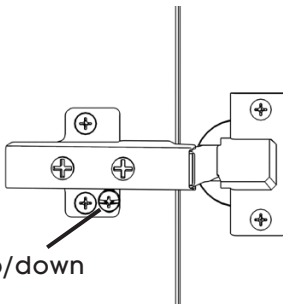

Use this adjustment to ensure that the doors are flush with the top and bottom panels.

Tip: Leave the screws tight enough to hold the door in place, but loose enough to remain adjustable.

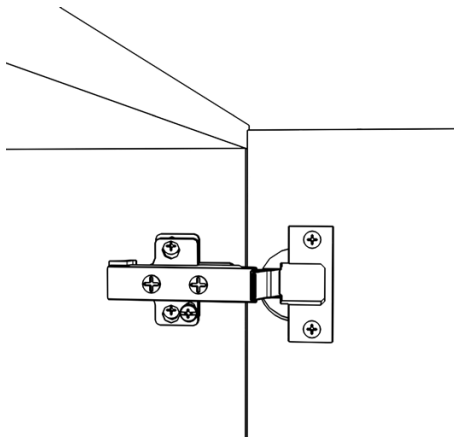

Door is adjusted down and sits below the top edge of the credenza

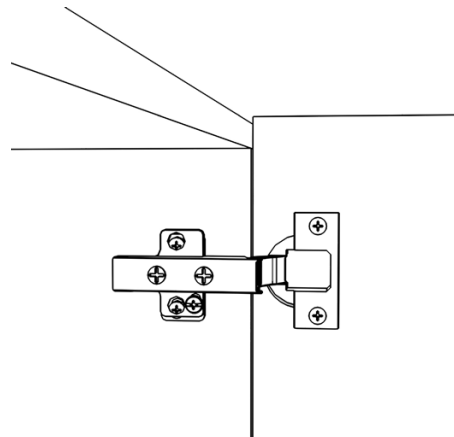

Door is adjusted up and sits above the top edge of the credenza

## Step 13: Add Plastic Bumpers

Stick a small plastic bumper to the top corner of each door. This will help with door adjustment

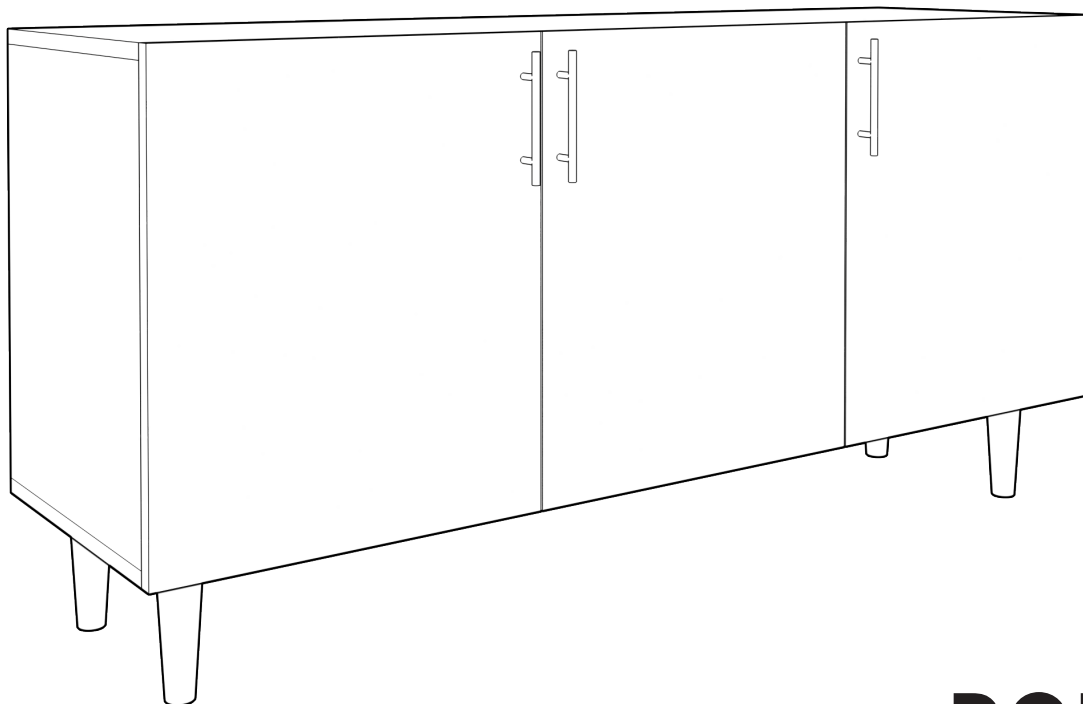
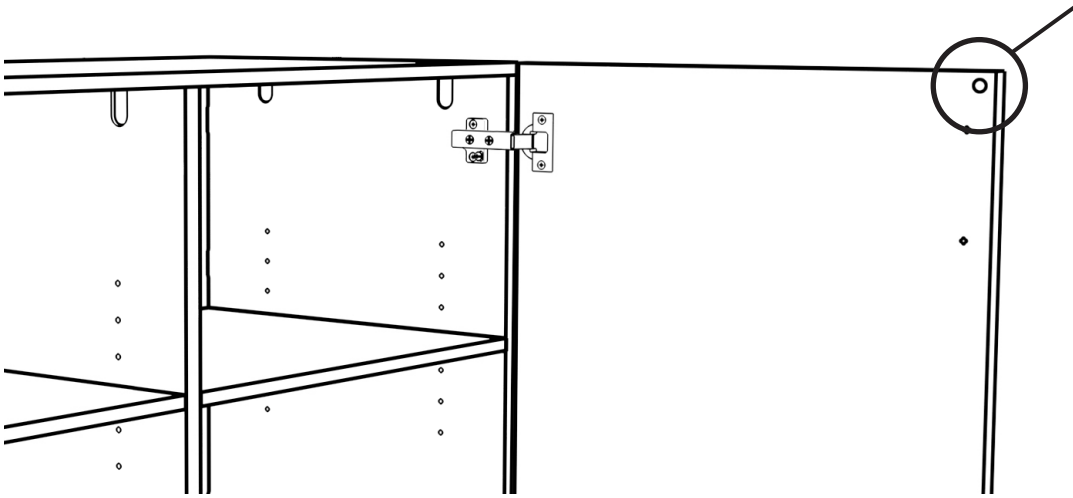

# DONE!